

Weld Half Union
CHBUW

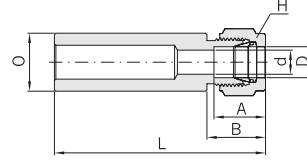

Connects Fractional Tubes

| Part No. | Tube O.D D | | d min | H Width across flat | | A | B | L | O |
|------------|---------------|-------|----------|------------------------|-------|-------|-------|--------|-------|
| | in | mm | | in | mm | | | | |
| CHBUW - 1 | 1/16 | 1.58 | 1.27 | 5/16 | 7.93 | 8.63 | 10.92 | 60.92 | 10.00 |
| CHBUW - 2 | 1/8 | 3.17 | 2.28 | 7/16 | 11.11 | 12.70 | 15.24 | 65.24 | 12.00 |
| CHBUW - 3 | 3/16 | 4.76 | 3.04 | 1/2 | 12.70 | 13.71 | 16.00 | 76.00 | 12.00 |
| CHBUW - 4 | 1/4 | 6.35 | 4.82 | 9/16 | 14.28 | 15.24 | 17.78 | 67.78 | 14.00 |
| CHBUW - 5 | 5/16 | 7.93 | 6.35 | 5/8 | 15.87 | 16.25 | 18.54 | 68.54 | 16.00 |
| CHBUW - 6 | 3/8 | 9.52 | 7.11 | 11/16 | 17.46 | 16.76 | 19.30 | 69.30 | 19.00 |
| CHBUW - 8 | 1/2 | 12.70 | 10.41 | 7/8 | 22.22 | 22.86 | 21.84 | 71.84 | 23.00 |
| CHBUW - 10 | 5/8 | 15.87 | 12.70 | 1 | 25.40 | 24.38 | 21.84 | 71.84 | 25.00 |
| CHBUW - 12 | 3/4 | 19.05 | 15.74 | 1-1/8 | 28.57 | 24.38 | 21.84 | 71.84 | 28.00 |
| CHBUW - 14 | 7/8 | 22.22 | 18.28 | 1-1/4 | 31.75 | 25.90 | 21.84 | 71.84 | 32.00 |
| CHBUW - 16 | 1 | 25.40 | 22.35 | 1-1/2 | 38.10 | 31.24 | 26.41 | 76.41 | 35.00 |
| CHBUW - 20 | 1 1/4 | 31.75 | 27.68 | 1-7/8 | 47.62 | 41.14 | 38.86 | 88.86 | 50.00 |
| CHBUW - 24 | 1 1/2 | 38.10 | 34.03 | 2-1/4 | 57.15 | 50.03 | 45.21 | 95.21 | 55.00 |
| CHBUW - 32 | 2 | 50.80 | 45.97 | 3 | 76.20 | 67.56 | 62.73 | 112.73 | 80.00 |

Connects Metric Tubes

| Part No. | Tube O.D D | d min | H Width across flat | A | B | L | O |
|-------------|---------------|----------|------------------------|------|------|------|------|
| CHBUW - 2M | 2 | 1.7 | 12 | 12.9 | 15.3 | 65.3 | 12.0 |
| CHBUW - 3M | 3 | 2.4 | 12 | 12.9 | 15.3 | 65.3 | 12.0 |
| CHBUW - 4M | 4 | 2.4 | 12 | 13.7 | 16.1 | 66.1 | 12.0 |
| CHBUW - 6M | 6 | 4.8 | 14 | 15.3 | 17.7 | 67.7 | 12.0 |
| CHBUW - 8M | 8 | 6.3 | 16 | 16.2 | 18.6 | 68.6 | 16.0 |
| CHBUW - 10M | 10 | 7.9 | 19 | 17.2 | 19.5 | 69.5 | 19.0 |
| CHBUW - 12M | 12 | 9.5 | 22 | 22.8 | 22.0 | 72.0 | 23.0 |
| CHBUW - 15M | 15 | 11.9 | 25 | 24.4 | 22.0 | 72.0 | 25.0 |
| CHBUW - 16M | 16 | 12.7 | 25 | 24.4 | 22.0 | 72.0 | 28.0 |
| CHBUW - 18M | 18 | 15.1 | 30 | 24.4 | 22.0 | 72.0 | 28.0 |
| CHBUW - 20M | 20 | 15.9 | 32 | 26.0 | 22.0 | 72.0 | 32.0 |
| CHBUW - 22M | 22 | 18.3 | 32 | 26.0 | 22.0 | 72.0 | 32.0 |
| CHBUW - 25M | 25 | 21.8 | 38 | 31.3 | 26.5 | 76.5 | 38.0 |
| CHBUW - 28M | 28 | 21.8 | 46 | 36.6 | 36.6 | 86.6 | 45.0 |
| CHBUW - 32M | 32 | 28.6 | 50 | 42.0 | 41.6 | 91.6 | 50.0 |
| CHBUW - 38M | 38 | 33.7 | 60 | 49.4 | 47.9 | 97.9 | 60.0 |

* Specified length to be shown as last designator in part number
Example : CHBUW-4L100

Thermocouple Weld Half Union
CHBUWT

Bore Through weld union handle thermocouple or dip tubes with ease. For correct part number, just add "T" as a suffix to CHBUW, the weld half union designator.

Example : CHBUWT-8-S316 1/2" tube stainless steel 316

All dimensions are in millimeters unless otherwise specified. Dimensions are for reference only, subject to change.