

Reducing Tee

**BTR**

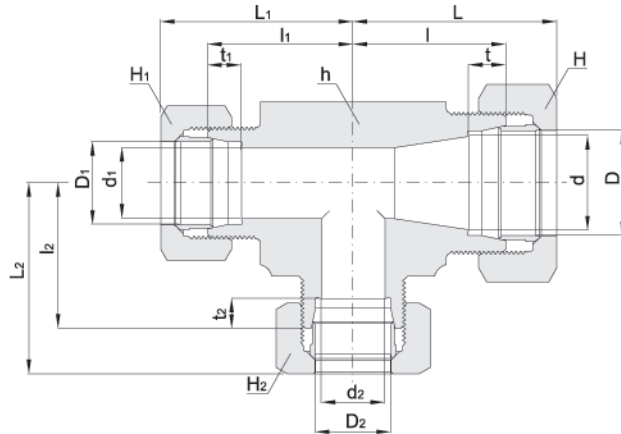

Basic Part Number	Tube O.D			*d	*d <sub>1</sub>	*d <sub>2</sub>	Width across flat				t	t <sub>1</sub>	t <sub>2</sub>	l	l <sub>1</sub>	l <sub>2</sub>	Approx		
	D	D <sub>1</sub>	D <sub>2</sub>				h	H	H <sub>1</sub>	H <sub>2</sub>							L	L <sub>1</sub>	L <sub>2</sub>
BTR08A08A10A	8	8	10	6	6	8	17	17	17	19	7.0	7.0	7.0	23	23	23	33.5	33.5	34.5
BTR10A10A08A	10	10	8	8	8	6	17	19	19	17	7.0	7.0	7.0	23	23	23	34.5	34.5	33.5
BTR08A08A12A	8	8	12	6	6	10	19	17	17	22	7.0	7.0	7.0	24	24	24	34.5	34.5	35.5
BTR12A08A08A	12	8	8	10	6	6	19	22	17	17	7.0	7.0	7.0	24	24	24	35.5	34.5	34.5
BTR12A12A08A	12	12	8	10	10	6	19	22	22	17	7.0	7.0	7.0	24	24	24	35.5	35.5	34.5
BTR12A10A10A	12	10	10	10	8	8	19	22	19	19	7.0	7.0	7.0	24	24	24	35.5	35.5	35.5
BTR12A12A10A	12	12	10	10	10	8	19	22	22	19	7.0	7.0	7.0	24	24	24	35.5	35.5	35.5
BTR12A10A12A	12	10	12	10	8	10	19	22	19	22	7.0	7.0	7.5	24	24	24	35.5	35.5	35.5
BTR10A10A15A	10	10	15	8	8	13	24	19	19	27	7.0	7.0	7.5	27	27	29	38.5	38.5	41.5
BTR12A12A15A	12	12	15	10	10	13	24	22	22	27	7.0	7.0	7.5	27	27	29	38.5	38.5	41.5
BTR15A15A10A	15	15	10	13	13	8	24	27	27	19	7.5	7.5	7.0	29	29	27	41.5	41.5	38.5
BTR15A15A12A	15	15	12	13	13	10	24	27	22	22	7.5	7.0	7.0	29	27	27	41.5	38.5	38.5
BTR15A15A12A	15	15	12	13	13	10	24	27	27	22	7.5	7.5	7.0	29	29	27	41.5	41.5	38.5
BTR15A12A15A	15	12	15	13	10	13	24	27	22	27	7.5	7.0	7.5	29	27	29	41.5	38.5	41.5
BTR12A12A16A	12	12	15	10	10	13	27	22	22	30	7.0	7.0	7.5	30	30	32	41.5	41.5	44.5
BTR16A16A08A	16	16	8	14	14	6	27	30	30	17	7.5	7.5	7.0	32	32	30	44.5	44.5	40.5
BTR16A16A10A	16	16	10	14	14	8	27	30	30	19	7.5	7.5	7.0	32	32	30	44.5	44.5	41.5
BTR16A16A12A	16	16	12	14	14	10	27	30	30	22	7.5	7.5	7.0	32	32	30	44.5	44.5	41.5
BTR12A12A18A	12	12	18	10	10	16	27	22	22	32	7.0	7.0	8.0	30	30	32	41.5	41.5	44.5
BTR18A10A10A	18	10	10	16	8	8	27	32	19	19	8.0	7.0	7.0	32	30	30	44.5	41.5	41.5
BTR18A18A10A	18	18	10	16	16	8	27	32	32	19	8.0	8.0	7.0	32	32	30	44.5	44.5	41.5
BTR18A18A12A	18	18	12	16	16	10	27	32	32	22	8.0	8.0	7.0	32	32	30	44.5	44.5	41.5
BTR18A18A15A	18	18	15	16	16	13	27	32	32	27	8.0	8.0	7.5	32	32	32	44.5	44.5	41.5
BTR18A10A18A	18	10	18	16	8	16	27	32	19	32	8.0	7.0	8.0	32	30	32	44.5	41.5	44.5
BTR16A16A20B	16	16	20	14	14	18	30	30	30	36	7.5	7.5	8.0	33	33	33	45.5	45.5	45.5

Tube Wall Thickness

A = 1.0t

B = 1.5t

C = 2.0t

\* Part 'd' can be changed according to buyer's tube specification.  
 Assembly instruction refers to the catalog number H-220TF.

Dimensions are reference only, subject to change.

Reducing Tee  
**BTR**

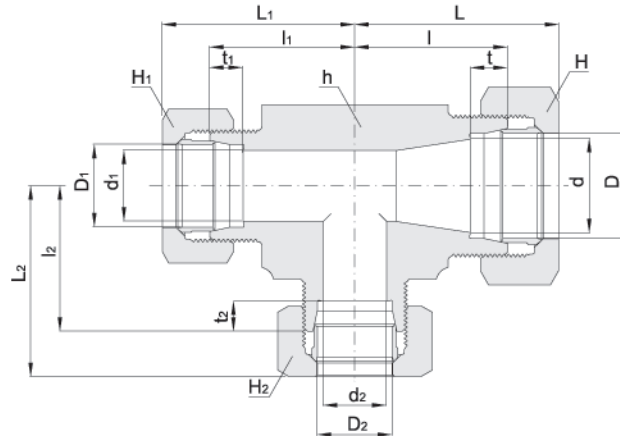

Basic Part Number	Tube O.D			*d	*d <sub>1</sub>	*d <sub>2</sub>	Width across flat				t	t <sub>1</sub>	t <sub>2</sub>	l	l <sub>1</sub>	l <sub>2</sub>	Approx		
	D	D <sub>1</sub>	D <sub>2</sub>				h	H	H <sub>1</sub>	H <sub>2</sub>							L	L <sub>1</sub>	L <sub>2</sub>
BTR20B20B10A	20	20	10	17	17	8	30	36	36	19	8	8.0	7.0	33	33	31	45.5	45.5	42.5
BTR20B20B12A	20	20	12	17	17	10	30	36	36	22	8	8.0	7.0	33	33	31	45.5	45.5	42.5
BTR20B20B16A	20	20	16	17	17	14	30	36	36	30	8	8.0	7.5	33	33	33	45.5	45.5	45.5
BTR22B22B10A	22	22	10	19	19	8	32	36	36	19	9	9.0	7.0	34	34	32	46.5	46.5	43.5
BTR22B22B12A	22	22	12	19	19	10	32	36	36	22	9	9.0	7.0	34	34	32	46.5	46.5	43.5
BTR22B15A15A	22	15	15	19	13	13	32	36	27	27	9	7.5	7.5	34	34	34	46.5	46.5	46.5
BTR22B22B15A	22	22	15	19	19	13	32	36	36	27	9	9.0	7.5	34	34	34	46.5	46.5	46.5
BTR22B18A18A	22	18	18	19	16	16	32	36	32	32	9	8.0	8.0	34	34	34	46.5	46.5	46.5
BTR22B18A22B	22	18	22	19	16	19	32	36	32	36	9	8.0	9.0	34	34	34	46.5	46.5	46.5
BTR20B20B25B	20	20	25	17	17	22	36	36	36	41	9	8.0	9.0	36	36	36	48.5	48.5	49.5
BTR25B25B16A	25	25	16	22	22	14	36	41	41	30	8	8.0	10.0	36	36	36	49.5	49.5	48.5
BTR25B25B20B	25	25	20	22	22	17	36	41	41	36	10	10.0	7.5	36	36	36	49.5	49.5	48.5
BTR28B28B10A	28	28	10	25	25	8	41	46	46	19	10	10.0	8.0	41	41	37	55.0	55.0	48.5
BTR28B28B12A	28	28	12	25	25	10	41	46	46	22	10	10.0	7.0	41	41	37	55.0	55.0	48.5
BTR28B28B15A	28	28	5	25	25	13	41	46	46	27	10	10.0	7.0	41	41	39	55.0	55.0	51.5
BTR28B28B18A	28	28	18	25	25	16	41	46	46	32	10	10.0	8.0	41	41	39	55.0	55.0	51.5
BTR28B22B22B	28	22	22	25	19	19	41	46	36	36	10	9.0	9.0	41	39	39	55.0	51.5	51.5
BTR28B28B22B	28	28	22	25	25	19	41	46	46	36	10	10.0	9.0	41	41	39	55.0	55.0	51.5
BTR25B25B30B	25	25	30	23	23	27	41	41	41	46	10	10.0	10.0	39	39	41	52.5	52.5	55.5
BTR86C22B22B	34	22	22	30	19	19	46	55	36	36	11	9.0	9.0	46	44	44	63.5	56.5	56.5
BTR86C22B86C	34	22	34	30	19	30	46	55	36	55	11	8.0	11.0	46	44	46	63.5	56.5	63.5
BTR86C28B28B	34	28	28	30	25	25	46	55	46	46	11	10.0	10.0	46	46	46	63.5	60.0	60.0
BTR86C28B86C	34	28	34	30	25	30	46	55	46	55	11	10.0	11.0	46	46	46	63.5	60.0	63.5
BTR86C86C22B	34	34	22	30	30	16	46	55	55	36	11	11.0	9.0	46	46				
BTR86C86C28B	34	34	28	30	30	25	46	55	55	46	11	11.0	10.0	46	46				

Tube Wall Thickness

A = 1.0t

B = 1.5t

C = 2.0t

\* Part 'd' can be changed according to buyer's tube specification.  
Assembly instruction refers to the catalog number H-220TF.

Dimensions are reference only, subject to change.