

# Medium Pressure Fittings

## Nipples

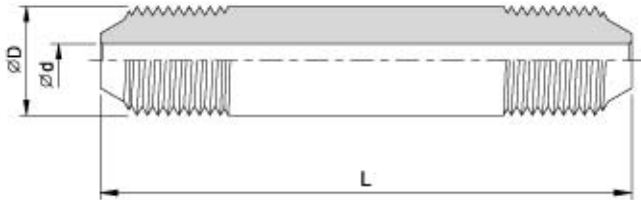

### Special Lengths

In addition to the standard lengths cataloged in the table below, nipples are available in any custom length. Consult factory.

### Materials

Catalog numbers in table refer to Type 316 stainless steel. Type 304 stainless steel nipples available. Consult factory.

## Pressure to 20,000psi

Catalog No.							O.D(D)	I.D(d)	Working Pressure at 100°F psi
2.75" Length(L)	3" Length(L)	4" Length(L)	6" Length(L)	8" Length(L)	10" Length(L)	12" Length(L)			
HPNP20K-4H02L	HPNP20K-4H03L	HPNP20K-4H04L	HPNP20K-4H06L	HPNP20K-4H08L	HPNP20K-4H10L	HPNP20K-4H12L	1/4"	0.109"	20,000
	HPNP20K-6H03L	HPNP20K-6H04L	HPNP20K-6H06L	HPNP20K-6H08L	HPNP20K-6H10L	HPNP20K-6H12L	3/8"	0.203"	20,000
		HPNP20K-9H04L	HPNP20K-9H06L	HPNP20K-9H08L	HPNP20K-9H10L	HPNP20K-9H12L	9/16"	0.312"	20,000
			HPNP20K-12H06L	HPNP20K-12H08L	HPNP20K-12H10L	HPNP20K-12H12L	3/4"	0.438"	20,000
			HPNP20K-16H06L	HPNP20K-16H08L	HPNP20K-16H10L	HPNP20K-16H12L	1"	0.562"	20,000

## Pressure to 10,000psi for Sour Gas Service Fittings

Catalog No.							O.D(D)	I.D(d)	Working Pressure at 100°F psi
2.75" Length(L)	3" Length(L)	4" Length(L)	6" Length(L)	8" Length(L)	10" Length(L)	12" Length(L)			
HPNP10K-4H02L-SOG	HPNP10K-4H03L-SOG	HPNP10K-4H04L-SOG	HPNP10K-4H06L-SOG	HPNP10K-4H08L-SOG	HPNP10K-4H10L-SOG	HPNP10K-4H12L-SOG	1/4"	0.109"	10,000
	HPNP10K-6H03L-SOG	HPNP10K-6H04L-SOG	HPNP10K-6H06L-SOG	HPNP10K-6H08L-SOG	HPNP10K-6H10L-SOG	HPNP10K-6H12L-SOG	3/8"	0.203"	10,000
		HPNP10K-9H04L-SOG	HPNP10K-9H06L-SOG	HPNP10K-9H08L-SOG	HPNP10K-9H10L-SOG	HPNP10K-9H12L-SOG	9/16"	0.312"	10,000
			HPNP10K-12H06L-SOG	HPNP10K-12H08L-SOG	HPNP10K-12H10L-SOG	HPNP10K-12H12L-SOG	3/4"	0.438"	10,000
			HPNP10K-16H06L-SOG	HPNP10K-16H08L-SOG	HPNP10K-16H10L-SOG	HPNP10K-16H12L-SOG	1"	0.562"	10,000