

Miniature 2- and 3-Way Solenoid Valves

A10 Series, 10mm Pilot Valves

Humphrey[®]

Humphrey A10 Series Pilot Valves are perfect for equipment or device makers requiring electrically controlled pneumatic signals in limited spaces. Available in 12VDC or 24VDC with perpendicular or axial plug-in electrical entry. Subbase mount, these normally closed direct-acting valves have a life expectancy up to 50 million cycles.

10 millimeters in width, A10 Pilot Valves feature highly saturated buna nitrile elastomers within a molded PBT body. Solenoid operator draws just 1 watt, delivering 15 SLPM flow to operate high flow work valves.

Plug-in 16-inch lead wire connector, subbase gasket and mounting screws are included.

FEATURES

- Compact 10mm wide valve body
- Low power consumption: 1 watt
- Excellent flow: 0.01 Cv
- Subbase, Manifold Mount
- Non-locking, recessed manual override (std)
- RoHS compliant

APPLICATIONS

- Mount directly to larger pilot operated work or process valves.
- Mount remotely (i.e. inside panel) and pilot operate work valves located near actuator or in harsh or dangerous environments.



A1037P



A1037A



A1037A

With Furnished Plug-In
Lead Connector

Pilot Valve Family



A10 SERIES
10mm, 2- and 3-Way



A15 SERIES
15mm, 2- and 3-Way



How to Order

A10 Series, 10mm Pilot Valves

A10	37	A	12VDC	A1037A12VDC
MODEL	ELECTRICAL ENTRY TYPE 37 - Plug-In	ELECTRICAL ENTRY DIRECTION A - Axial P - Perpendicular	VOLTAGE 12VDC 24VDC	ACCESSORY 46934 - Wire Connector (Replacement; 1 piece)

Miniature Solenoid Valves

A10 Series, 10mm Pilot Valves

SPECIFICATIONS	A10
TYPE OF OPERATION	Direct-Acting
FUNCTION	2- and 3-Way, NC
PIPING TYPE (OPTIONS)	Subbase, Manifold (Manifold mtg screws and gasket included. For 2-way, omit manifold's PORT 3.)
MEDIA	Air or Inert Gas
PRESSURE RANGE – PSI (BAR)	0 ~ 100 (6.9)
FLOW CAPACITY @ 100 PSI	15 SLPM
ESEOD* – IN (MM)	0.021 (0.53)
FLOW COEFFICIENT (Cv)	0.01
AMBIENT TEMPERATURE RANGE	14° to 122° F (-10° to 50°C)
LUBRICATION	Not Required
OPERATING SPEED (CPM)	2,400
ELECTRICAL ENTRY	Perpendicular Plug-In w/16" lead wires
WEIGHT (OZ)	0.3
WETTED MATERIAL	PBT, PET, HNBR, SST
POWER CONSUMPTION (WATTS)	1.0 MAX
VOLTAGE	12VDC, 24VDC
VOLTAGE RANGE	+/- 10%
OVERRIDE	Non-Locking Manual
COMPLIANCE	RoHS, REACH

* ESEOD: Equivalent Sharp Edge Orifice Diameter

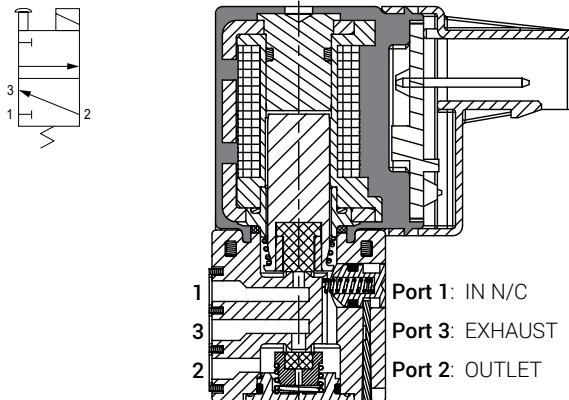

DIMENSIONAL DRAWINGS

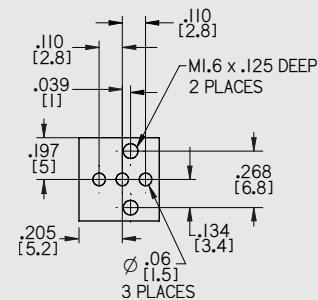
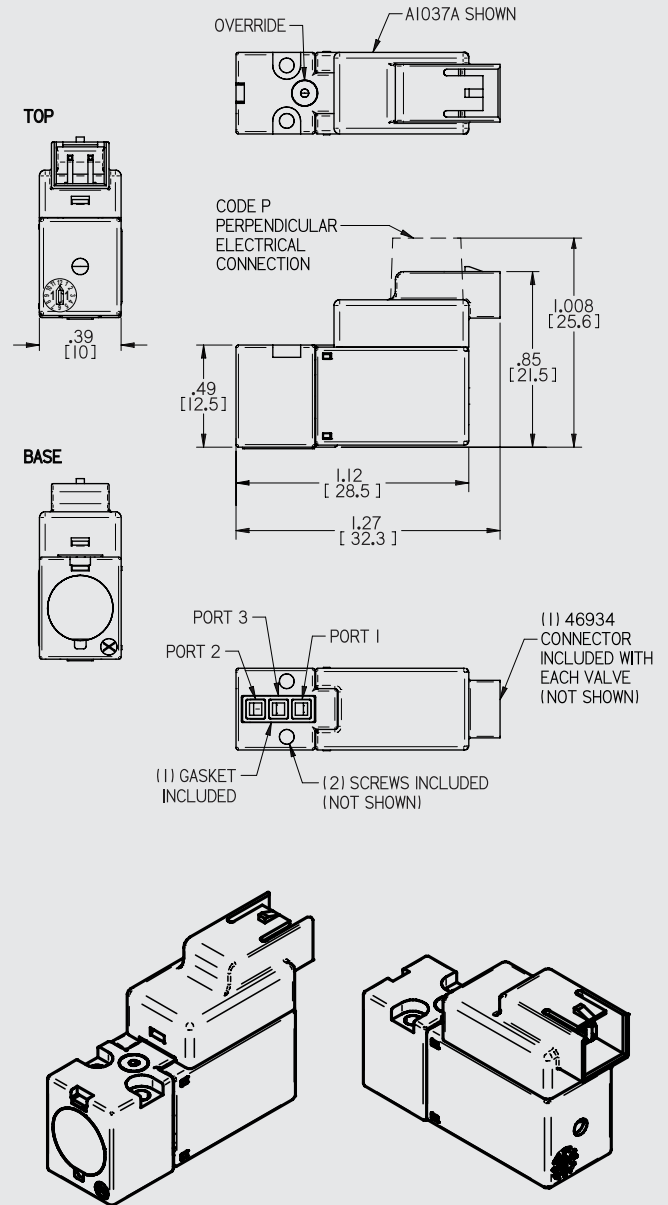

[] = mm

Certified: ISO 9001:2015

HUMPHREY-PRODUCTS.COM

A privately owned US company since 1901.

© 2023 Humphrey Products Company

Printed in U.S.A.

IDSA10PV23

Humphrey Products Company

5070 East N Avenue

Kalamazoo, MI 49048 USA

P: 269.381.5500

F: 269.381.4113

Humphrey