

USE FOLDOVER GAGE FOR SPC.

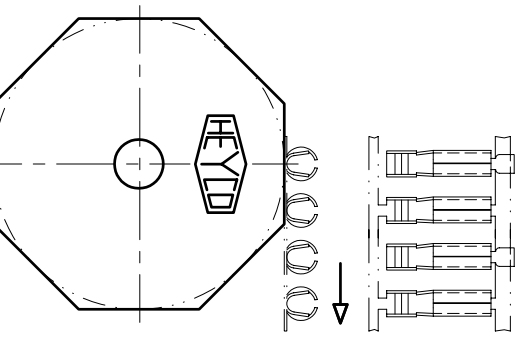

UNWINDING INFORMATION

FEED FROM LEFT TO RIGHT
CRIMP IN FRONT & UPRIGHT

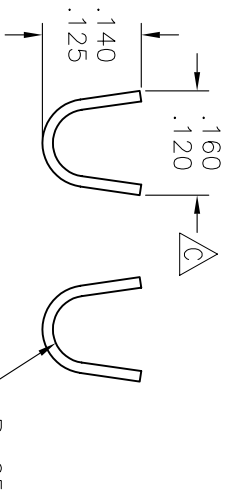
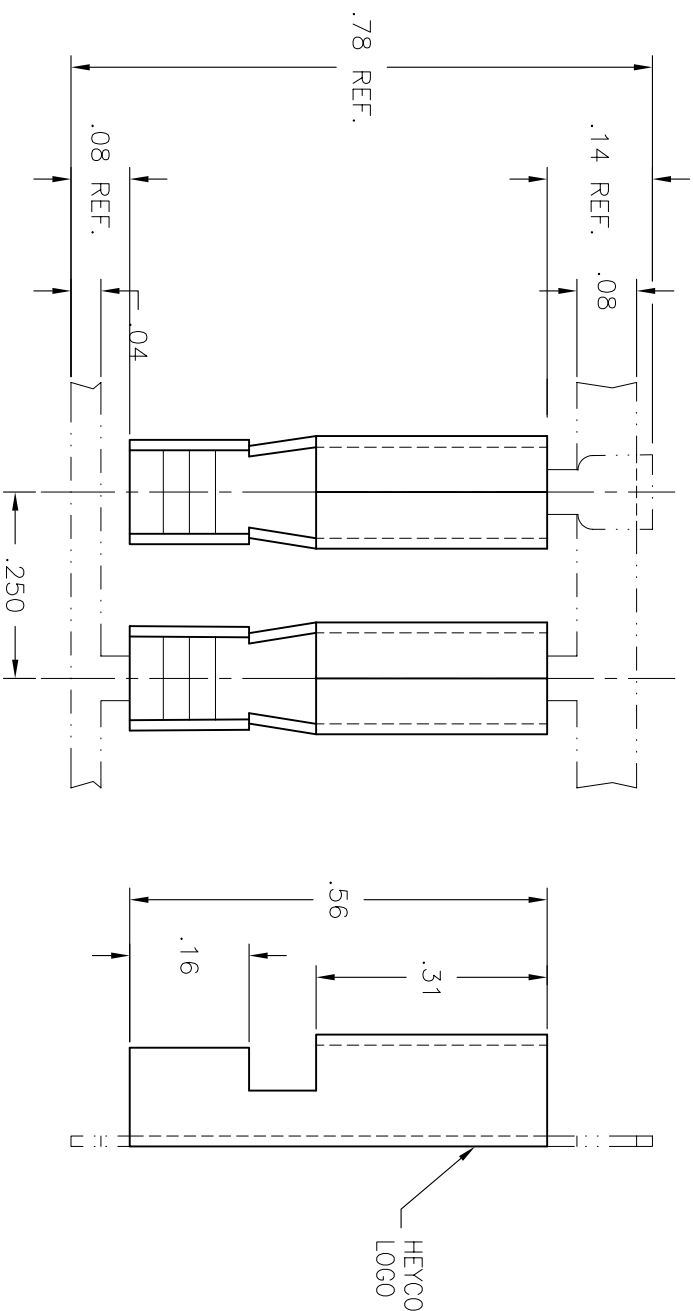

NOTE:

1.) CRITICAL DIMENSION TO BE CHECKED AS PART OF THE IN-PROCESS INSPECTION (SPC).

HEYCO
 HEYCO PRODUCTS, INC.
 TOMS RIVER, NEW JERSEY
 (732) 286-1800 FAX (732) 244-8843

PART DRAWING

| | | | |
|---|------------------------|-----------|--|
| TOLERANCES +/-: .XX=.01 .XXX=.005 ANG.=2° | | | |
| MATL: BRASS | FINISH: | | |
| THICK: .014 | WIRE STRIP LENGTH: .19 | | |
| WIRE RANGE (AWG): 18-16 | | | |
| TOOLING: UNW. DIE-A011, PUNCH-C180, ANVL-C181 | | | |
| DIE BASE-N/A, PUNCHES-N/A, ANVLS-N/A | | | |
| DRAWN: TMC | REVISED: MEG | APPROVED: | |
| DATE: 12-9-91 | DATE: 07/02/01 | DATE: | |

TVR-122

| | | |
|-------------|----------------|----------|
| 7307 | 7307-001 | F |
| PART NUMBER | CATALOG NUMBER | REVISION |