

NOTES:

- 1.) REFER TO UL1681 PAGE 10, FIG. C1.5, AND CLAUSE 4.12.2 IN CSA C22.2 WHICH REFERENCES NEMA WD-16-1988.
- 2.) CRITICAL DIMENSION TO BE CHECKED AS PART OF THE IN-PROCESS INSPECTION (SPC).

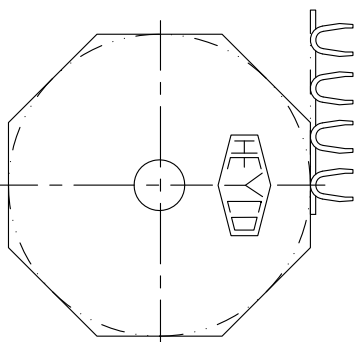
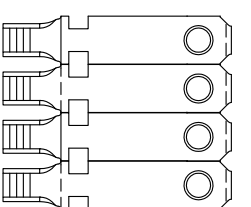

UNWINDING INFORMATION
 FEED FROM LEFT TO RIGHT
 CRIMP IN FRONT & UPRIGHT

HEYCO

HEYCO PRODUCTS, INC.
 TOMS RIVER, NEW JERSEY
 (732) 286-4336 FAX (732) 244-8843

PART DRAWING

TOLERANCES +/-: .XX=.01 .XXX=.005 ANG.=2°

MATL.: BRASS FINISH:

THICK: .028 WIRE STRIP LENGTH: .25

WIRE RANGE (AWG): 14-10

TOOLING: UNIV. DIE-A001, PUNCH-C245, ANVIL-C264
 DIE BASE- N/A, PUNCHES-N/A, ANVILS-N/A

DRAWN: PIH	REVISED: MEG	APPROVED:
DATE: 08/06/91	DATE: 6/7/01	DATE:

116-N-R/L

DESCRIPTION

5655	5670-602	K
PART NUMBER	CATALOG NUMBER	REVISION



LS-91824

