

ZT 442 Series

One Piece Body Design

Material:	PPH, Kynar® PVDF , Halar® E-CTFE
Size:	1/2" - 4"
Pressure Rating:	232psi (1/2" - 2" PPH, Kynar® PVDF) 150psi (2 1/2" - 4" PPH, Kynar® PVDF) 150psi (1/2" - 4" PEHD)
Seats:	PTFE
Seals:	PTFE, EPDM, FEP, FKM
Connections:	Metric Butt Fusion



ISO 9002 CERTIFIED

Engineering Guide Specification

Materials of Construction:

PP: Class PP 110B76383 per ASTM D4101

Kynar® PVDF: Type 1 per ASTM D3222

Halar® E-CTFE: Type 1 per ASTM D792

Special Features

- Uni-body design eliminates fugitive emissions
- Ideal for highly corrosive fluids
- Light weight design
- PTFE chevron packing
- Full port design
- Available with out internal elastomers
- Low maintenance and extended operational life
- Rugged industrial design
- Cost effective alternative to stainless steel, exotic alloy or PTFE lined valves

Flow Rate in Gallons Per Minute

Size	1/2"	3/4"	1"	1 1/4"	1 1/2"	2"	2 1/2"	3"	4"
Cv	12.5	28	51	81	150	230	360	485	768

Cv is the number of gallons per minute of water at a temperature of 68°F that will flow through a valve with a 1 psi pressure differential at a specified travel.

Pressure/Temperature Graph: Working PSI/Fahrenheit

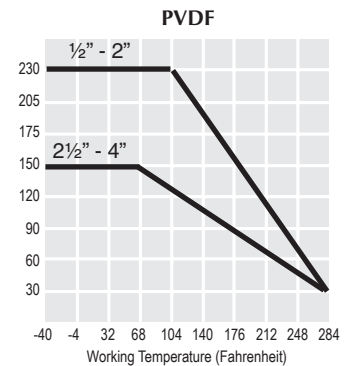
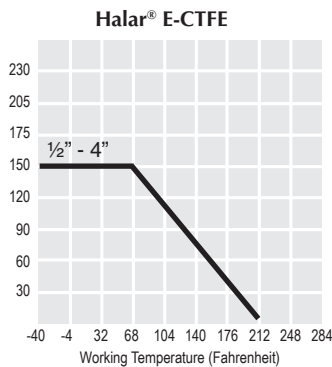
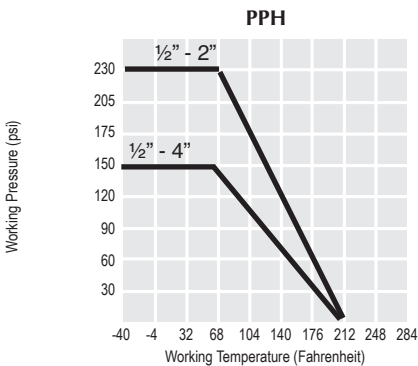

ZT 442 Series

Dimensional Data

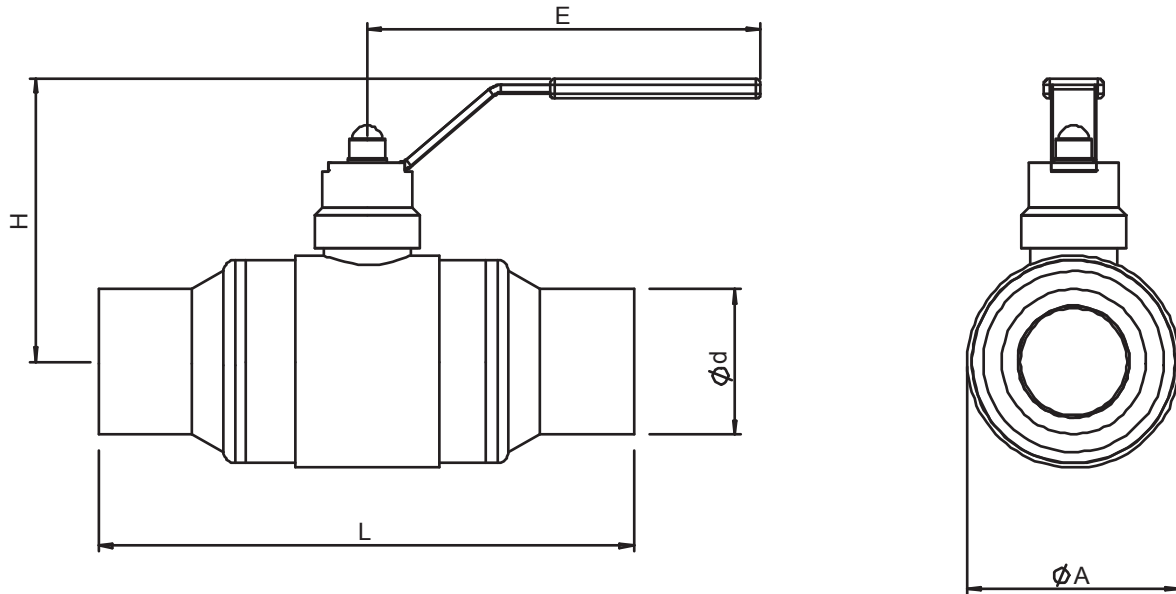

Nom. Size	A	d	E	H	L
1/2"	1.69	0.79	2.87	1.99	5.12
3/4"	2.20	0.98	6.06	3.94	5.91
1"	2.20	1.26	6.06	3.94	6.30
1 1/4"	3.07	1.57	7.17	4.84	7.09
1 1/2"	3.07	1.97	7.17	4.84	7.87
2"	3.86	2.48	7.17	5.24	9.06
2 1/2"	4.92	2.95	8.46	7.99	11.02
3"	4.92	3.54	8.46	7.99	11.65
4"*	4.92	4.33	8.46	7.99	13.23

*Reduced Port

Parts Listing

1. Body
2. Flat Stem Seat
3. Conical Stem Seat
4. Drive Socket
5. Handel
6. Washer
7. Nut
8. Cap

