



**MATERIAL:** Carbon Steel or Stainless Steel

**METRIC COMPONENT CATALOG NUMBER**

A 1  2 MY K 0 5 0

**MATERIAL CODE**

Carbon Steel **C**

300 Series Stainless Steel **X**

**No. of Teeth Code**

No. of Teeth Code	No. of Teeth	Fig. No.	P.D.	D Dia.	d Bore H8	D <sub>1</sub> Hub Dia.	F Face Width
<b>Carbon Steel</b>							
010	10	1	5	6	—	6	10
012	12	1	6	7	—	7	10
014	14	1	7	8	—	8	10
015	15	2	7.5	8.5	3	8.5	8
016	16	2	8	9	3	9	8
018	18	2	9	10	4	10	8
020	20	2	10	11	4	11	8
<b>Stainless Steel</b>							
010	10	1	5	6	—	6	10
012	12	1	6	7	—	7	10
014	14	1	7	8	—	8	10
015	15	1	7.5	8.5	—	8.5	10
016	16	2	8	9	4	9	8
018	18	2	9	10	4	10	8
020	20	2	10	11	4	11	8

**FIG. 1**

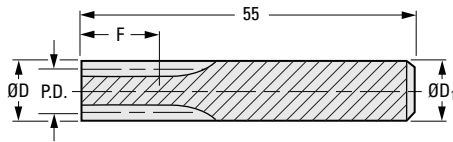

**FIG. 2**

