

> MATERIAL:

303 Stainless Steel

PHONE: 516.328.3300 • FAX: 516.326.8827 • WWW.SDP-SI.COM

> SPECIFICATIONS:

Tolerances	
Decimals	± .01
Fractions	± 1/32



Stainless Steel Socket Head Cap Screw Supplied

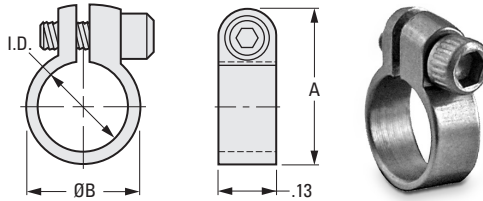

INCH COMPONENT

Catalog Number	I.D. +.002 -.000	A ± .016	B Dia.	Screw Size	Clearance Radius
303 Stainless Steel					
S3503Y-J058	.125	.305	.190	#2-56	9/32
S3503Y-J059	.187	.370	.250	#2-56	5/16
S3503Y-J060	.250	.435	.310	#2-56	11/32

> MATERIAL:

303 Stainless Steel
2024-T351 Aluminum

> SPECIFICATIONS:

Tolerances	
Decimals	± .01
Fractions	± 1/32

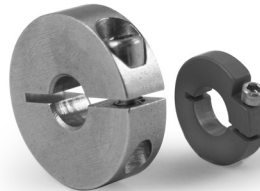

Stainless Steel Socket Head Cap Screw Supplied

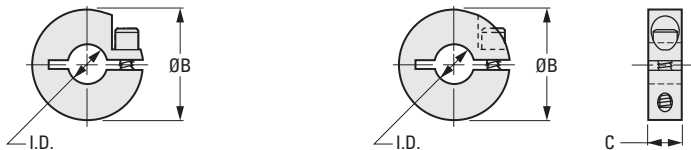

NOTE: Notched style will be discontinued when stock is depleted. Either style may be supplied at SI option.

INCH COMPONENT

Catalog Number		Shaft Size	I.D. +.002 -.000	B Dia.	C	Screw Size	Clearance Radius
303 Stainless Steel	2024-T351 Aluminum						
S3501Y-J062	S3501Y-J065	.125	.188	7/8	.250	#6-32	33/64
S3501Y-J063	S3501Y-J066	.187	.250	7/8	.250	#6-32	33/64
S3501Y-J064	S3501Y-J067	.250	.313	7/8	.250	#6-32	33/64
S3501Y-J068	S3501Y-J071	.093	.125	5/8	.156	#2-56	3/8
S3501Y-J069	S3501Y-J072	.125	.188	5/8	.156	#2-56	3/8
S3501Y-J070	S3501Y-J073	.187	.250	5/8	.156	#2-56	3/8
S3501Y-J074	S3501Y-J077	.093	.125	9/16	.156	#2-56	3/8
S3501Y-J075	S3501Y-J078	.125	.188	9/16	.156	#2-56	3/8
S3501Y-J076	S3501Y-J079	.187	.250	9/16	.156	#2-56	3/8
S3501Y-J075M	S3501Y-J078M	.125	.188	9/16	.125	#1-72	3/8
S3501Y-J076M	S3501Y-J079M	.187	.250	9/16	.125	#1-72	3/8