

**MATERIAL:**

- Carbon Steel, Zinc Plated
- 303 Stainless Steel
- 416 Stainless Steel (Rc 38-45)
- 416 Stainless Steel (Rc 38-45) Black Oxide

**SPECIFICATIONS:**

| Tolerances |        |
|------------|--------|
| Decimals   | ± .005 |
| Fractions  | ± 1/64 |

Stainless Steel Socket Head  
Cap Screw Supplied

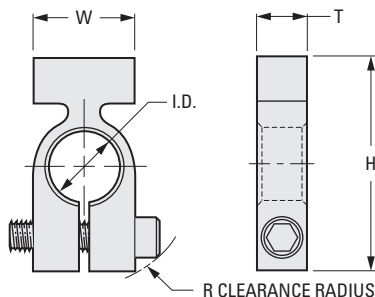
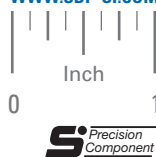

**INCH COMPONENT**

| Catalog Number                                     | Shaft Size | I.D.<br>+.001<br>-.000 | H      | T    | W    | Screw Size | R     |
|--|------------|------------------------|--------|------|------|------------|-------|
| <b>Carbon Steel, Zinc Plated</b>                   |            |                        |        |      |      |            |       |
| S3300Y-C098  | 1/8        | .188                   | 11/16  | .140 | .312 | #2-56      | 27/64 |
| S3300Y-C099  | 3/16       | .251                   | 51/64  | .140 | .375 | #2-56      | 1/2   |
| S3300Y-C100  | 1/4        | .313                   | 13/16  | .140 | .437 | #2-56      | 33/64 |
| S3300Y-C101  | 5/16       | .376                   | 7/8    | .140 | .500 | #2-56      | 9/16  |
| S3300Y-C102  | 3/8        | .438                   | 1-1/32 | .140 | .625 | #2-56      | 41/64 |
| S3300Y-C083  | 1/8        | .188                   | 11/16  | .250 | .312 | #6-32      | 27/64 |
| S3300Y-C084  | 3/16       | .251                   | 51/64  | .250 | .375 | #6-32      | 1/2   |
| S3300Y-C085  | 1/4        | .313                   | 13/16  | .250 | .437 | #6-32      | 33/64 |
| S3300Y-C086  | 5/16       | .376                   | 7/8    | .250 | .500 | #6-32      | 9/16  |
| S3300Y-C087  | 3/8        | .438                   | 1-1/32 | .250 | .625 | #6-32      | 41/64 |
| <b>303 Stainless Steel</b>                         |            |                        |        |      |      |            |       |
| S3300Y-C088  | 1/8        | .188                   | 11/16  | .250 | .312 | #6-32      | 27/64 |
| S3300Y-C089  | 3/16       | .251                   | 51/64  | .250 | .375 | #6-32      | 1/2   |
| S3300Y-C090  | 1/4        | .313                   | 13/16  | .250 | .437 | #6-32      | 33/64 |
| S3300Y-C091  | 5/16       | .376                   | 7/8    | .250 | .500 | #6-32      | 9/16  |
| S3300Y-C092  | 3/8        | .438                   | 1-1/32 | .250 | .625 | #6-32      | 41/64 |
| <b>416 Stainless Steel (Rc 38-45)</b>              |            |                        |        |      |      |            |       |
| S3300Y-C160  | 1/8        | .188                   | 11/16  | .240 | .312 | #6-32      | 27/64 |
| S3300Y-C161  | 3/16       | .250                   | 13/16  | .240 | .375 | #6-32      | 1/2   |
| S3300Y-C162  | 1/4        | .312                   | 13/16  | .240 | .437 | #6-32      | 33/64 |
| <b>416 Stainless Steel (Rc 38-45), Black Oxide</b> |            |                        |        |      |      |            |       |
| S3300Y-C163  | 1/8        | .188                   | 11/16  | .240 | .312 | #6-32      | 27/64 |
| S3300Y-C164  | 3/16       | .250                   | 13/16  | .240 | .375 | #6-32      | 1/2   |
| S3300Y-C165  | 1/4        | .312                   | 13/16  | .240 | .437 | #6-32      | 33/64 |