

# HUBLESS NONMETALLIC SPUR GEARS • 72 PITCH



AGMA 10  
3/16 FACE  
3/8 BORE  
20° PRESSURE ANGLE

PHONE: 516.328.3300 • FAX: 516.326.8827 • WWW.SDP-SI.COM

**> MATERIAL:**

Acetal

Available on special order:  
14-1/2° P.A., teeth not listed  
or different bore size.

This product is also available with  
Fairloc® hubs or pin type hubs.  
See our Web site: [www.sdp-si.com](http://www.sdp-si.com)

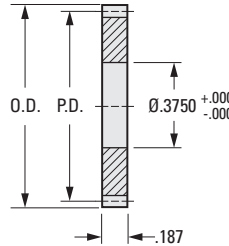
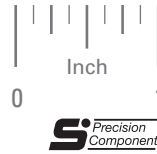
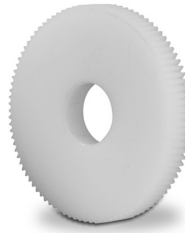

**INCH COMPONENT  
CATALOG NUMBER**

S 1 2 8 8 Z - 0 7 2 D

No. of  
Teeth  
Code

No. of Teeth Code	No. of Teeth	P.D.	O.D.
040	40	.5555	.583
041	41	.5694	.597
042	42	.5833	.611
043	43	.5972	.625
044	44	.6111	.639
045	45	.6250	.653
046	46	.6388	.667
048	48	.6666	.694
050	50	.6944	.722
054	54	.7500	.778
060	60	.8333	.861
066	66	.9166	.944
072	72	1.0000	1.028
075	75	1.0416	1.069
080	80	1.1111	1.139
084	84	1.1666	1.194
096	96	1.3333	1.361
099	99	1.3750	1.403
100	100	1.3888	1.417
108	108	1.5000	1.528
120	120	1.6666	1.694
126	126	1.7500	1.778
127	127	1.7638	1.792
132	132	1.8333	1.861
135	135	1.8750	1.903
140	140	1.9444	1.972
144	144	2.0000	2.028
150	150	2.0833	2.111
160	160	2.2222	2.250
180	180	2.5000	2.528

