

AGMA 10
3/16 FACE
3/16 & 1/4 BORE
20° PRESSURE ANGLE

PHONE: 516.328.3300 • FAX: 516.326.8827 • WWW.SDP-SI.COM

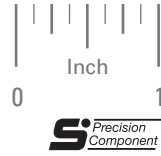
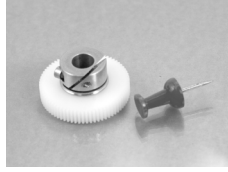

> MATERIAL:

Gear - Acetal
Hub - 303 Stainless Steel

> SPECIFICATIONS:

For Fairloc® Type Hub Gear

| B Bore Ref. | C | E |
|-------------|------|------|
| .1873 | .438 | .453 |
| .2498 | .530 | .483 |

Available on special order:
14-1/2° P.A., teeth
not listed or different bore size.

This product is also available with
pin type hubs.
See our Web site: www.sdp-si.com

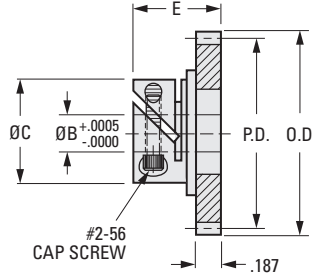

**INCH COMPONENT
CATALOG NUMBER**

S 1 V 8 Z - 072 D S

No. of
Teeth
Code

| Bore Code | B Bore |
|-----------|--------|
| 4 | .1873 |
| 6 | .2498 |

| No. of Teeth Code | No. of Teeth | P.D. | O.D. |
|-------------------|--------------|--------|-------|
| 040 | 40 | .5555 | .583 |
| 041 | 41 | .5694 | .597 |
| 042 | 42 | .5833 | .611 |
| 043 | 43 | .5972 | .625 |
| 044 | 44 | .6111 | .639 |
| 045 | 45 | .6250 | .653 |
| 046 | 46 | .6388 | .667 |
| 048 | 48 | .6666 | .694 |
| 050 | 50 | .6944 | .722 |
| 054 | 54 | .7500 | .778 |
| 060 | 60 | .8333 | .861 |
| 066 | 66 | .9166 | .944 |
| 072 | 72 | 1.0000 | 1.028 |
| 075 | 75 | 1.0416 | 1.069 |
| 080 | 80 | 1.1111 | 1.139 |
| 084 | 84 | 1.1666 | 1.194 |
| 096 | 96 | 1.3333 | 1.361 |
| 099 | 99 | 1.3750 | 1.403 |
| 100 | 100 | 1.3888 | 1.417 |
| 108 | 108 | 1.5000 | 1.528 |
| 120 | 120 | 1.6666 | 1.694 |
| 126 | 126 | 1.7500 | 1.778 |
| 127 | 127 | 1.7638 | 1.792 |
| 132 | 132 | 1.8333 | 1.861 |
| 135 | 135 | 1.8750 | 1.903 |
| 140 | 140 | 1.9444 | 1.972 |
| 144 | 144 | 2.0000 | 2.028 |
| 150 | 150 | 2.0833 | 2.111 |
| 160 | 160 | 2.2222 | 2.250 |
| 180 | 180 | 2.5000 | 2.528 |

