

AGMA 10
 3/32 FACE
 1/8 BORE
 20° PRESSURE ANGLE

PHONE: 516.328.3300 • FAX: 516.326.8827 • WWW.SDP-SI.COM

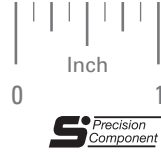

> MATERIAL:

- 303 Stainless Steel
- 2024 Aluminum, Anodized
- T4 or T351 Aluminum Alloy, anodized before cutting

Available on special order:
 14-1/2° P.A., teeth not listed, different bore size and/or material, passivation for Stainless Steel.

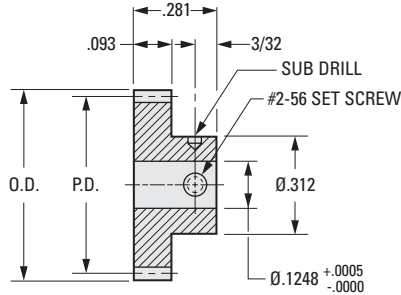
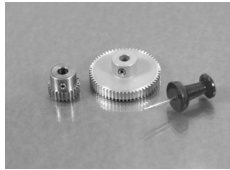
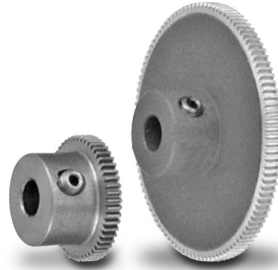

INCH COMPONENT

Catalog Number		No. of Teeth	P.D.	O.D.
303 Stainless Steel	2024 Aluminum Anodized			
S1043Z-120S028	S1043Z-120A028	28 Δ	.2333	.250
S1043Z-120S029	S1043Z-120A029	29 Δ	.2417	.258
S1043Z-120S030	S1043Z-120A030	30 Δ	.2500	.267
S1043Z-120S035	S1043Z-120A035	35 Δ	.2917	.308
S1043Z-120S040	S1043Z-120A040	40	.3333	.350
S1043Z-120S041	S1043Z-120A041	41	.3417	.358
S1043Z-120S045	S1043Z-120A045	45	.3750	.392
S1043Z-120S048	S1043Z-120A048	48	.4000	.417
S1043Z-120S050	S1043Z-120A050	50	.4167	.433
S1043Z-120S054	S1043Z-120A054	54	.4500	.467
S1043Z-120S060	S1043Z-120A060	60	.5000	.517
S1043Z-120S065	S1043Z-120A065	65	.5417	.558
S1043Z-120S070	S1043Z-120A070	70	.5833	.600
S1043Z-120S072	S1043Z-120A072	72	.6000	.617
S1043Z-120S080	S1043Z-120A080	80	.6667	.683
S1043Z-120S084	S1043Z-120A084	84	.7000	.717
S1043Z-120S090	S1043Z-120A090	90	.7500	.767
S1043Z-120S096	S1043Z-120A096	96	.8000	.817
S1043Z-120S100	S1043Z-120A100	100	.8333	.850
S1043Z-120S108	S1043Z-120A108	108	.9000	.917
S1043Z-120S110	S1043Z-120A110	110	.9167	.933
S1043Z-120S120	S1043Z-120A120	120	1.0000	1.017
S1043Z-120S144	S1043Z-120A144	144	1.2000	1.217
S1043Z-120S150	S1043Z-120A150	150	1.2500	1.267
S1043Z-120S156	S1043Z-120A156	156	1.3000	1.317
S1043Z-120S162	S1043Z-120A162	162	1.3500	1.367
S1043Z-120S168	S1043Z-120A168	168	1.4000	1.417

Δ Hob cuts into hub. Hub diameter never exceeds gear O.D.

