

3 mm FACE WIDTH
20° PRESSURE ANGLE

PHONE: 516.328.3300 • FAX: 516.326.8827 • WWW.SDP-SI.COM

► **MATERIAL:**
Acetal

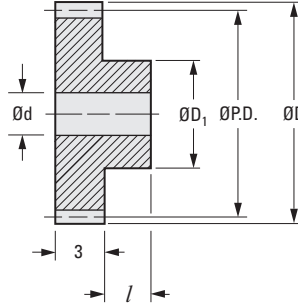

METRIC COMPONENT

Catalog Number	No. of Teeth	P.D.	D Dia.	d Bore Dia.	D ₁ Hub Dia.	l Hub Proj.
A 1M 2MYZ05012	12	6	7	2	4	4
A 1M 2MYZ05013	13	6.5	7.5	2	4	4
A 1M 2MYZ05014	14	7	8	2	5	4
A 1M 2MYZ05015	15	7.5	8.5	3	6	7
A 1M 2MYZ05016	16	8	9	3	6	7
A 1M 2MYZ05017	17	8.5	9.5	3	6	7
A 1M 2MYZ05018	18	9	10	4	8	7
A 1M 2MYZ05019	19	9.5	10.5	4	8	7
A 1M 2MYZ05020A	20	10	11	3	8	7
A 1M 2MYZ05020	20	10	11	4	8	7
A 1M 2MYZ05021	21	10.5	11.5	4	8	7
A 1M 2MYZ05022	22	11	12	4	10	7
A 1M 2MYZ05023	23	11.5	12.5	4	10	7
A 1M 2MYZ05024	24	12	13	4	10	7
A 1M 2MYZ05025	25	12.5	13.5	4	10	7
A 1M 2MYZ05025A	25	12.5	13.5	6	10	7
A 1M 2MYZ05026	26	13	14	4	10	7
A 1M 2MYZ05026A	26	13	14	6	10	7
A 1M 2MYZ05027	27	13.5	14.5	4	10	7
A 1M 2MYZ05028	28	14	15	4	10	7
A 1M 2MYZ05030	30	15	16	4	12	7
A 1M 2MYZ05032	32	16	17	4	12	7
A 1M 2MYZ05035	35	17.5	18.5	4	12	7
A 1M 2MYZ05036	36	18	19	4	12	7
A 1M 2MYZ05038	38	19	20	4	12	7

Continued on the next page

- I
- R
- T
- 1**
- 2
- 3
- 4
- 5
- 6
- 7
- 8
- 9
- 10
- 11
- 12
- 13
- 14
- 15
- A

3 mm FACE WIDTH
20° PRESSURE ANGLE

PHONE: 516.328.3300 • FAX: 516.326.8827 • WWW.SDP-SI.COM

► MATERIAL:
Acetal

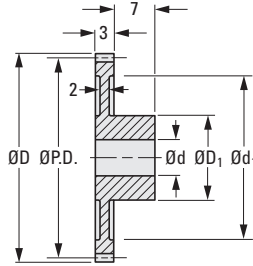
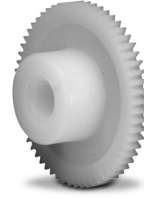

METRIC COMPONENT

Catalog Number	No. of Teeth	P.D.	D Dia.	d Bore Dia.	D ₁ Hub Dia.	d ₁ Dia.
* A 1M 2MYZ05040	40	20	21	4	12	14.5
A 1M 2MYZ05042	42	21	22	4	12	16
A 1M 2MYZ05045	45	22.5	23.5	4	12	18.5
A 1M 2MYZ05048	48	24	25	6	15	19
A 1M 2MYZ05050	50	25	26	6	15	20
A 1M 2MYZ05052	52	26	27	6	15	21
A 1M 2MYZ05054	54	27	28	6	15	22
A 1M 2MYZ05055	55	27.5	28.5	6	15	23
A 1M 2MYZ05056	56	28	29	6	15	23
A 1M 2MYZ05060	60	30	31	6	15	24
A 1M 2MYZ05064	64	32	33	6	15	25
A 1M 2MYZ05065	65	32.5	33.5	6	15	27
A 1M 2MYZ05070	70	35	36	6	15	29
A 1M 2MYZ05072	72	36	37	6	15	30
A 1M 2MYZ05075	75	37.5	38.5	6	15	33
A 1M 2MYZ05080	80	40	41	6	15	36
A 1M 2MYZ05090	90	45	46	6	15	39
A 1M 2MYZ05096	96	48	49	6	15	42
A 1M 2MYZ05100	100	50	51	6	15	44
A 1M 2MYZ05120	120	60	61	6	15	54

* Coring opposite hub only.

Continued from the previous page