

3 mm FACE WIDTH
20° PRESSURE ANGLE

> MATERIAL:

Gear – Acetal
Insert – Brass

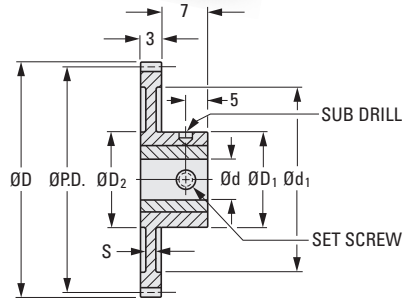
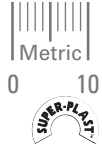

METRIC COMPONENT

Catalog Number	No. of Teeth	P.D.	D Dia.	d Bore +0.025 0	D ₁ Hub Dia.	S	d ₁ Dia.	D ₂ Dia.	Set Screw
A 1Z 2MYZ0501803	18	9	10	3	8	–	–	–	M2.5
A 1Z 2MYZ0501903	19	9.5	10.5	3	8	–	–	–	M2.5
A 1Z 2MYZ0502003	20	10	11	3	8	–	–	–	M2.5
A 1Z 2MYZ0502103	21	10.5	11.5	3	8	–	–	–	M2.5
A 1Z 2MYZ0502204	22	11	12	4	10	–	–	–	M2.5
A 1Z 2MYZ0502304	23	11.5	12.5	4	10	–	–	–	M2.5
A 1Z 2MYZ0502404	24	12	13	4	10	–	–	–	M2.5
A 1Z 2MYZ0502504	25	12.5	13.5	4	10	–	–	–	M2.5
A 1Z 2MYZ0502604	26	13	14	4	10	–	–	–	M2.5
A 1Z 2MYZ0502704	27	13.5	14.5	4	10	–	–	–	M2.5
A 1Z 2MYZ0502804	28	14	15	4	10	–	–	–	M2.5
A 1Z 2MYZ0503004	30	15	16	4	12	–	–	–	M2.5
A 1Z 2MYZ0503204	32	16	17	4	12	–	–	–	M2.5
A 1Z 2MYZ0503504	35	17.5	18.5	4	12	–	–	–	M2.5
A 1Z 2MYZ0503604	36	18	19	4	12	–	–	–	M2.5
A 1Z 2MYZ0503804	38	19	20	4	12	–	–	–	M2.5
A 1Z 2MYZ0504004	40	20	21	4	12	2	14	12	M2.5
A 1Z 2MYZ0504204	42	21	22	4	12	2	16	12	M2.5
A 1Z 2MYZ0504504	45	22.5	23.5	4	12	2	18.5	12	M2.5
A 1Z 2MYZ0504806	48	24	25	6	15	2	19	15	M3
A 1Z 2MYZ0505006	50	25	26	6	15	2	20	15	M3
A 1Z 2MYZ0505206	52	26	27	6	15	2	21	15	M3
A 1Z 2MYZ0505406	54	27	28	6	15	2	22	15	M3
A 1Z 2MYZ0505506	55	27.5	28.5	6	15	2	23	15	M3
A 1Z 2MYZ0505606	56	28	29	6	15	2	23	15	M3
A 1Z 2MYZ0506006	60	30	31	6	15	2	24	15	M3
A 1Z 2MYZ0506406	64	32	33	6	15	2	25	15	M3
A 1Z 2MYZ0506506	65	32.5	33.5	6	15	2	27	15	M3
A 1Z 2MYZ0507006	70	35	36	6	15	2	29	15	M3
A 1Z 2MYZ0507206	72	36	37	6	15	2	30	15	M3
A 1Z 2MYZ0507506	75	37.5	38.5	6	15	2	33	15	M3
A 1Z 2MYZ0508006	80	40	41	6	15	2	36	15	M3
A 1Z 2MYZ0509006	90	45	46	6	15	2	39	15	M3
A 1Z 2MYZ0509606	96	48	49	6	15	2	42	15	M3
A 1Z 2MYZ0510006	100	50	51	6	15	2	44	15	M3
A 1Z 2MYZ0512006	120	60	61	6	15	2	54	15	M3