

ISO CLASS 7  
 5 mm FACE  
 8 mm BORE  
 20° PRESSURE ANGLE

**> MATERIAL:**

303 Stainless Steel or  
 2024 Aluminum Anodized  
 T4 or T351 Aluminum Alloy,  
 anodized before cutting.

Available on special order:  
 Number of teeth not listed,  
 different bore size and/or material,  
 passivation for Stainless Steel.

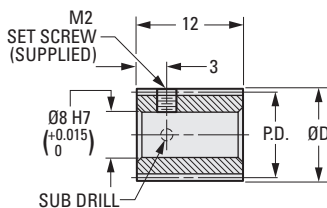
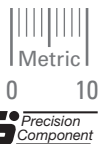
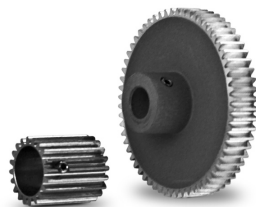

Fig. 1

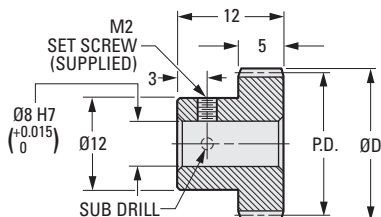

Fig. 2

**METRIC COMPONENT**

Catalog Number		No. of Teeth	P.D.	D Dia.
303 Stainless Steel	2024 Aluminum Anodized			
<b>Fig. 1</b>				
S10T05M020S0508	S10T05M020A0508	20	10	11
S10T05M021S0508	S10T05M021A0508	21	10.5	11.5
S10T05M022S0508	S10T05M022A0508	22	11	12
<b>Fig. 2</b>				
S10T05M024S0508	S10T05M024A0508	24	12	13
S10T05M025S0508	S10T05M025A0508	25	12.5	13.5
S10T05M026S0508	S10T05M026A0508	26	13	14
S10T05M028S0508	S10T05M028A0508	28	14	15
S10T05M030S0508	S10T05M030A0508	30	15	16
S10T05M032S0508	S10T05M032A0508	32	16	17
S10T05M036S0508	S10T05M036A0508	36	18	19
S10T05M042S0508	S10T05M042A0508	42	21	22
S10T05M048S0508	S10T05M048A0508	48	24	25
S10T05M050S0508	S10T05M050A0508	50	25	26
S10T05M055S0508	S10T05M055A0508	55	27.5	28.5
S10T05M060S0508	S10T05M060A0508	60	30	31
S10T05M064S0508	S10T05M064A0508	64	32	33
S10T05M070S0508	S10T05M070A0508	70	35	36
S10T05M072S0508	S10T05M072A0508	72	36	37
S10T05M075S0508	S10T05M075A0508	75	37.5	38.5
S10T05M080S0508	S10T05M080A0508	80	40	41
S10T05M084S0508	S10T05M084A0508	84	42	43
S10T05M090S0508	S10T05M090A0508	90	45	46
S10T05M096S0508	S10T05M096A0508	96	48	49
S10T05M100S0508	S10T05M100A0508	100	50	51
S10T05M108S0508	S10T05M108A0508	108	54	55
S10T05M110S0508	S10T05M110A0508	110	55	56
S10T05M120S0508	S10T05M120A0508	120	60	61
S10T05M128S0508	S10T05M128A0508	128	64	65
S10T05M168S0508	S10T05M168A0508	168	84	85
S10T05M198S0508	S10T05M198A0508	198	99	100