

ISO CLASS 7
 3 mm FACE
 5 mm BORE
 20° PRESSURE ANGLE

PHONE: 516.328.3300 • FAX: 516.326.8827 • WWW.SDP-SI.COM

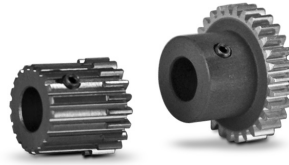

> MATERIAL:

303 Stainless Steel or
 2024 Aluminum Anodized-
 T4 or T351 Aluminum Alloy,
 anodized before cutting.

Available on special order:
 Number of teeth not listed, different
 bore size and /or material, passivation
 for stainless steel.

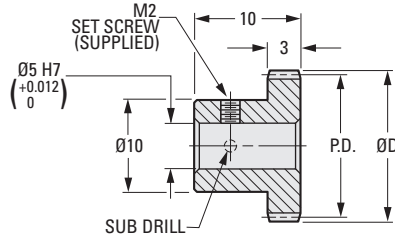

METRIC COMPONENT

Catalog Number		No. of Teeth	P.D.	D Dia.
303 Stainless Steel	2024 Aluminum Anodized			
S10T05M020S0305	S10T05M020A0305	20*	10	11
S10T05M021S0305	S10T05M021A0305	21*	10.5	11.5
S10T05M022S0305	S10T05M022A0305	22	11	12
S10T05M024S0305	S10T05M024A0305	24	12	13
S10T05M025S0305	S10T05M025A0305	25	12.5	13.5
S10T05M028S0305	S10T05M028A0305	28	14	15
S10T05M030S0305	S10T05M030A0305	30	15	16
S10T05M032S0305	S10T05M032A0305	32	16	17
S10T05M034S0305	S10T05M034A0305	34	17	18
S10T05M036S0305	S10T05M036A0305	36	18	19
S10T05M040S0305	S10T05M040A0305	40	20	21
S10T05M042S0305	S10T05M042A0305	42	21	22
S10T05M046S0305	S10T05M046A0305	46	23	24
S10T05M048S0305	S10T05M048A0305	48	24	25
S10T05M050S0305	S10T05M050A0305	50	25	26
S10T05M060S0305	S10T05M060A0305	60	30	31
S10T05M064S0305	S10T05M064A0305	64	32	33
S10T05M070S0305	S10T05M070A0305	70	35	36
S10T05M072S0305	S10T05M072A0305	72	36	37
S10T05M080S0305	S10T05M080A0305	80	40	41
S10T05M084S0305	S10T05M084A0305	84	42	43
S10T05M090S0305	S10T05M090A0305	90	45	46
S10T05M096S0305	S10T05M096A0305	96	48	49
S10T05M105S0305	S10T05M105A0305	105	52.5	53.5
S10T05M120S0305	S10T05M120A0305	120	60	61
S10T05M132S0305	S10T05M132A0305	132	66	67
S10T05M144S0305	S10T05M144A0305	144	72	73
S10T05M156S0305	S10T05M156A0305	156	78	79
S10T05M168S0305	S10T05M168A0305	168	84	85
S10T05M192S0305	S10T05M192A0305	192	96	97

* Hob cuts into hub. Hub diameter never exceeds gear O.D.

- I
- R
- T
- 1
- 2
- 3
- 4
- 5
- 6
- 7
- 8
- 9
- 10
- 11
- 12
- 13
- 14
- 15
- A