

MODULE 0.25, 0.4, 0.5, 1
20° PRESSURE ANGLE

PHONE: 516.328.3300 • FAX: 516.326.8827 • WWW.SDP-SI.COM



> MATERIAL:

Steel

> SPECIFICATION:

** Shaft Tolerance: 6 mm 0/-0.018
8 mm 0/-0.022

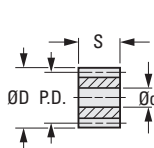

Fig. 1

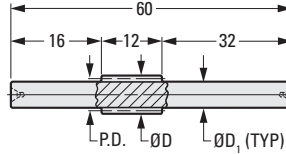

Fig. 2

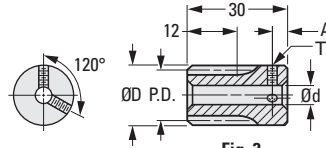

Fig. 3

The projections shown are per ISO convention.

METRIC COMPONENT

Catalog Number	No. of Teeth	P.D.	D Dia.	d Bore	d Tolerance	S Face Width	D ^{**} Shaft Dia. h8	A	T Set Screw
Module 0.25 Fig. 1									
A 1C 8MYSH2013	13	3.25	3.75	2	-0.01/-0.03	2.5	—	—	—
A 1C 8MYSH2013A				1.5		4			
A 1C 8MYSH2016	16	3.9	4.4	2		2.5			
A 1C 8MYSH2016A				1.5		4			
A 1C 8MYSH2019	19	4.75	5.25	2		2.5			
A 1C 8MYSH2019A				1.5		4			
Module 0.4 Fig. 1									
A 1C 8MYS04012	12	4.88	5.68	3	-0.014/-0.03	4	—	—	—
A 1C 8MYS04014A	14	5.84	6.64			4			
A 1C 8MYS04014B									
Module 0.5 Fig. 1									
A 1C 8MYS05012	12	6.2	7.2	4	-0.02/-0.04	4	—	—	—
Module 1 Fig. 2									
ΔA 1C 8MYK10008	8	8	10.64	—	—	—	6	—	—
ΔA 1C 8MYK10010	10	10	12.66				8		
Module 1 Fig. 3									
A 1C 8MYK10012S	12	12	14	6	+0.018/0	—	—	5	M4
A 1C 8MYK10014S	14	14	16						M5
A 1C 8MYK10015S	15	15	17						
A 1C 8MYK10016S	16	16	18	8	+0.022/0	—	—	4	M4
A 1C 8MYK10018S	18	18	20						

Δ To obtain additional tooth strength, these pinions are produced by shifting the tooth profile which results in a long addendum. The center distance for these pinions has to be increased. Therefore, please consult our Engineering Department.